

Two-Piece Magnetic Actuated Reed Switches

- AC and DC models
- Short-axis slide-by, head-on or ferromagnetic vane operation modes
- Compatible with solid state logic level inputs
- Internal dry reed switch
- Hermetically sealed contacts
- Heavy duty aluminum housings
- 1/2" NPT conduit outlet

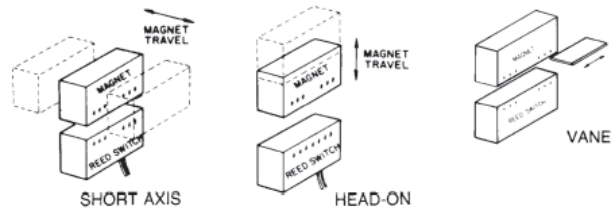

Modes of Operation



Magnet Actuator (Must be ordered separately)

Model No.21FR1-B

Temperature Effects

Temperature must be taken into consideration when using magnetically operated switches. The sensing ranges given on the following pages are for head-on operations at room temperature (75° F). Sub-zero temperatures can cause permanently reduced sensitivity. Use the following table as a guide for potential sensitivity loss.

Model	Maximum Possible Sensitivity Loss
20FR1-6B	2.03mm
20FR5-6B	4.95mm
20FR3-6B	1.52mm

Special Proximity Sensors

23mm to 61mm Sensing Range

Specials Magnetic Reed Switches

Specifications		2-wire Contact		
SENSING RANGE		22.9mm	61mm	61mm
SHIELDED		No	No	No
MODEL NUMBER(S)	AC:	20FR3-6B		
	DC:		20FR1-6B	20FR5-6B
OUTPUT		SPST relay, N.O.	SPST relay, N.O.	SPST relay, N.C.
POWER RATING	AC:	250VAC, 2A, 500VA	—	—
	DC:	—	400VDC, 1A, 15W	500VDC, 1.5A, 20W
MECHANICAL LIFE		5x10 ⁵ operations	1x10 ⁷ operations	1x10 ⁷ operations
LED(s)		No	No	No
RELEASE POINT		40.6mm	76.2mm	76.2mm
HYSTERESIS		17.8mm	15.2mm	15.2mm
ELECTROMAGNETIC COMPATIBILITY COMPLIANCE		NEMA ICS5-2000 See page 6	NEMA ICS5-2000 See page 6	NEMA ICS5-2000 See page 6
PROTECTION IEC		IP68	IP68	IP68
AMBIENT TEMPERATURE		-20°F to +200°F	-20°F to +200°F	-20°F to +200°F
HOUSING MATERIAL		Aluminum	Aluminum	Aluminum
SENSING FACE		Aluminum	Aluminum	Aluminum
APPROVALS	General Purpose	Yes	Yes	Yes
	General Purpose	Yes	Yes	Yes
	Nonincendive	Yes	Yes	Yes
ELECTRICAL CONNECTION		1.83-meter cable, PVC jacket, 2-conductor, #16AWG	1.83-meter cable, PVC jacket, 2-conductor, #16AWG	1.83-meter cable, PVC jacket, 2-conductor, #16AWG

Dimensions (mm)

20FR SENSOR

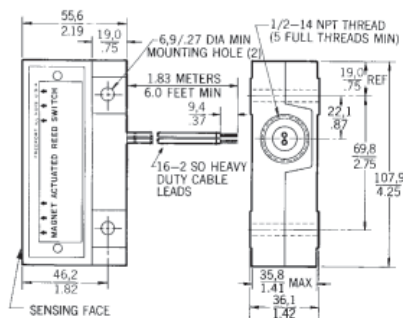

21FR1-B MAGNET ACTUATOR

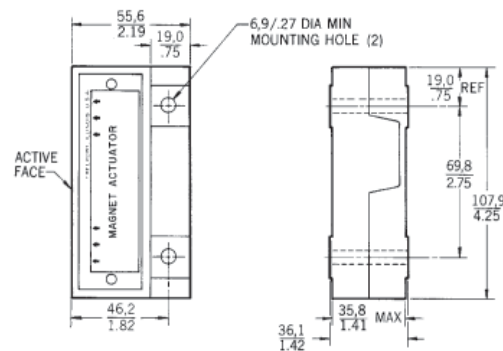

MOUNTING BRACKET

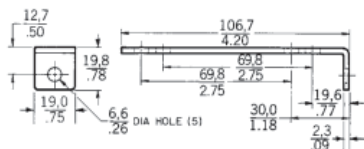

This mounting bracket is supplied with each 20FR Series Switch

MOUNTING BRACKET

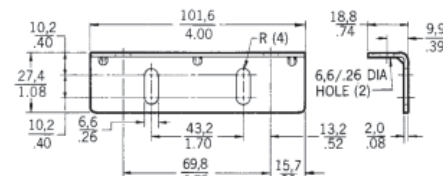

This mounting bracket is supplied with each 21FR1-B magnet